



Electrolux

Modular Cooking Range Line 700XP Full Module Gas Lava Stone Grill Top

ITEM # _____
MODEL # _____
NAME # _____
SIS # _____
AIA # _____



Electrolux

Modular Cooking Range Line
700XP Full Module Gas Lava Stone Grill Top



Modular Cooking Range Line
700XP Full Module Gas Lava Stone Grill Top
371045 (E7GRGHL00) Full module gas lava stone
grill top

Short Form Specification

Item No. _____

To be installed on open base installations, bridging supports or cantilever systems. Suitable for natural gas or LPG. 14 kW stainless steel gas burners with flame failure device. Gas burners protected by stainless steel deflection trays preventing blockage from foreign objects. Cooking surface grids in cast iron, easily removable for cleaning. Exterior panels in stainless steel with Scotch Brite finish. One piece pressed work top in 1.5 mm thick stainless steel. Right-angled side edges to allow flush-fitting junction between units.

APPROVAL: _____

Main Features

- Unit to be mounted on open base cupboards, bridging supports or cantilever systems.
- Heating via Stainless steel gas burners with flame failure device.
- Burners protected by stainless steel deflection trays to prevent blockage.
- Piezo ignition and separate controls for each half module.
- Cast iron grids can be adjusted on two levels.
- Stainless steel high splash guards on the rear and sides of cooking surface. Splash guards can be easily removed for cleaning and are dishwasher-safe.
- IPX4 water resistance certification.

Construction

- All exterior panels in Stainless Steel with Scotch Brite finishing.
- One piece pressed 1.5 mm work top in Stainless steel.
- Model has right-angled side edges to allow flush fitting joints between units, eliminating gaps and possible dirt traps.

Included Accessories

- 1 of Scraper for free standing grills PNC 206422

Optional Accessories

- Draught diverter, 150 mm diameter PNC 206132
☐
- Matching ring for flue condenser, 150 mm diameter PNC 206133
☐
- Kit 4 wheels - 2 swivelling with brake - it is mandatory to install base support and wheels PNC 206135
☐
- Support for bridge type installation, 800mm PNC 206137
☐
- Support for bridge type installation, 1000mm PNC 206138
☐
- Support for bridge type installation, 1200mm PNC 206139
☐
- Support for bridge type installation, 1400mm PNC 206140
☐
- Support for bridge type installation, 1600mm PNC 206141
☐
- Flue condenser for 1 module, 150 mm diameter PNC 206246
☐
- Chimney upstand, 800mm PNC 206304
☐
- Right and left side handrails PNC 206307
☐
- Base support for feet or wheels - 800mm (700/900) PNC 206367
☐
- Rear paneling - 800mm (700/900) PNC 206374
☐
- Rear paneling - 1000mm (700/900) PNC 206375
☐
- Rear paneling - 1200mm (700/900) PNC 206376
☐
- Chimney grid net, 400mm (700XP/900) PNC 206400
☐
- Frontal handrail, 800mm PNC 216047
☐
- Frontal handrail, 1200mm PNC 216049
☐
- Frontal handrail, 1600mm PNC 216050
☐
- Large handrail - portioning shelf, 400mm PNC 216185
☐
- Large handrail - portioning shelf, 800mm PNC 216186
☐
- 2 side covering panels for top appliances PNC 216277
☐
- Pressure regulator for gas units PNC 927225
☐



Electrolux

Modular Cooking Range Line 700XP Full Module Gas Lava Stone Grill Top

Front

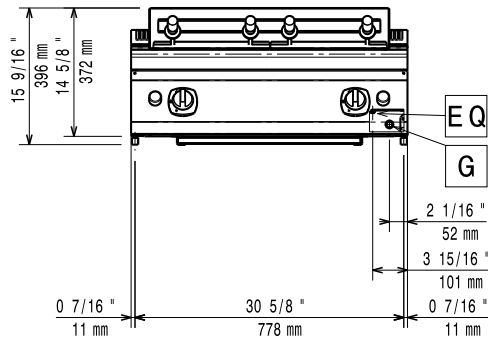

Top

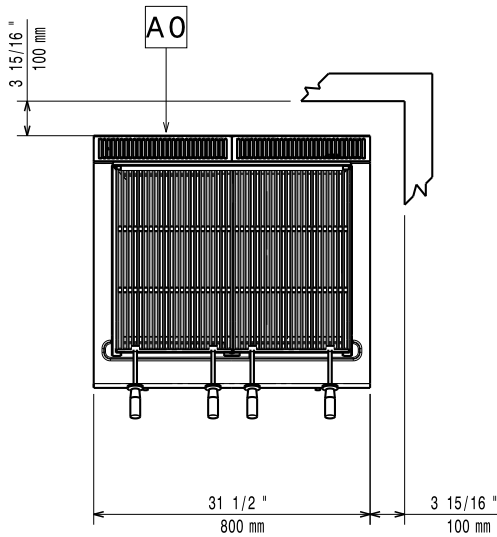

- EQ = Equipotential screw
- F = Fumes outlet
- G = Gas connection

Side

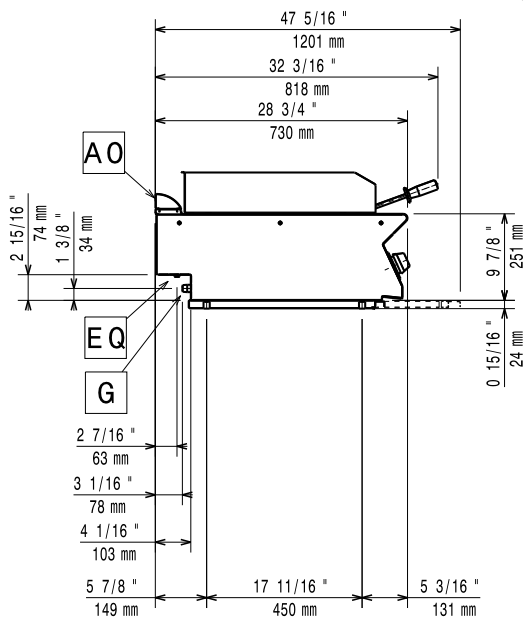

Gas

Gas Power:

371045 (E7GRGHLC00)

47726 Btu/hr (14 kW)

Standard gas delivery:

Natural Gas

Gas Type Option:

LPG; Natural Gas; Town

Gas Inlet:

1/2"

Key Information:

Cooking surface width: 641 mm

Cooking surface depth: 478 mm

Net weight: 64 kg

Shipping weight: 90 kg

Shipping height: 520 mm

Shipping width: 820 mm

Shipping depth: 860 mm

Shipping volume: 0.37 m³

If appliance is set up or next to or against temperature sensitive furniture or similar, a safety gap of approximately 150 mm should be maintained or some form of heat insulation fitted.



Modular Cooking Range Line
700XP Full Module Gas Lava Stone Grill Top

The company reserves the right to make modifications to the products without prior notice. All information correct at time of printing.

2016.08.26