



Electrolux

EMPower Static Gas Oven Base 36"

ITEM # _____

MODEL # _____

NAME # _____

SIS # _____

AIA # _____



Electrolux

EMPower
Static Gas Oven Base 36"



EMPower

Static Gas Oven Base 36"

169152 (AFG36)

EMPower Restaurant Range
gas static oven base, 36" -
freestanding with 6"
adjustable, removable legs

Short Form Specification

Item No. _____

Unit to be Electrolux 915 mm Static Gas Oven Base. Suitable for natural gas or propane gas. Special heavy duty chrome plated knobs for durability and easy cleaning. The configuration of bezels and knobs provides high level of protection against water infiltrations. Supplied with 150 mm height adjustable, removable legs. Unit may be installed on castors. 610 mm static oven 10 kW with unique baffle above the burner distributes heat to provide even cooking temperatures throughout the cavity. Vitreous enameled oven interior accommodates two standard Imperial full size 457 mm x 660 mm sheet pans. The interior is 497 mm w x 680 mm d x 380 mm h. 100% safety pilot. Manual oven shut-off valve. Heavy duty thermostat with temperature range from 70°C to 310°C. Oven supplied with two stainless steel tray racks.

Main Features

Oven Information:

- 24" (610 mm) static oven 34,000 BTU/hr (10 kW) with unique baffle above the burner distributes heat to provide even cooking temperatures throughout the cavity.
- Vitreous enameled oven interior accommodates two standard Imperial full size 18" x 26" (457 mm x 660 mm) sheet pans.
- The interior is 19-1/2" w x 26-3/4" d x 15" h (497 mm w x 680 mm d x 380 mm h).
- 100% safety pilot.
- Manual oven shut-off valve.
- Heavy duty thermostat with temperature range from 158° F to 590°F (70°C to 310°C).
- Oven supplied with two stainless steel tray racks.

General Information:

- Worktop in AISI 304 Stainless Steel.
- Front and side panels in Stainless Steel with Scotch Brite finish.
- Special heavy duty chrome plated knobs for durability and easy cleaning.
- The configuration of bezels and knobs provides high level of protection against water infiltrations.
- Supplied with 6" (150 mm) height adjustable, removable legs.
- Unit may be installed on castors.
- Included Accessories: propane converter kit, pressure regulator and main shut off valve.

Construction

- Pins to install up to 3 top units are supplied with the oven base (12 pins included in set).
- Gas pressure regulator is supplied with the unit.

Optional Accessories

- | | |
|---|-------------------------------------|
| • Backshelf to wall installation 36" units | PNC 169099 |
| • Portioning shelf 12" | <input type="checkbox"/> PNC 169173 |
| • Portioning shelf 16" | <input type="checkbox"/> PNC 169174 |
| • Portioning shelf 24" | <input type="checkbox"/> PNC 169175 |
| • Portioning shelf 36" | <input type="checkbox"/> PNC 169176 |
| • 4 wheels, 2 with bakes, for refrigerated and freezer base, H=125mm - US | <input type="checkbox"/> PNC 880234 |

APPROVAL: _____

Electrolux Professional, Inc.

www.electroluxusa.com/professional

10200 David Taylor Drive, Charlotte, NC 28262 • Telephone Number: 866-449-4200 • Fax Number: 704-547-7401



Electrolux

EMPower Static Gas Oven Base 36"

Front

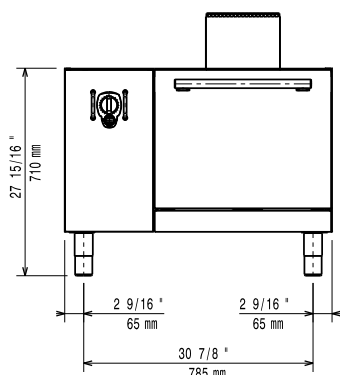

Top

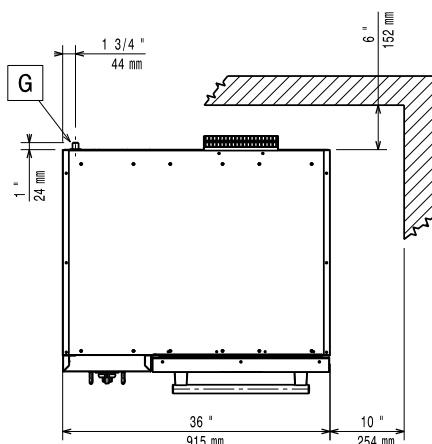

EQ = Equipotential screw

G = Gas connection

Side

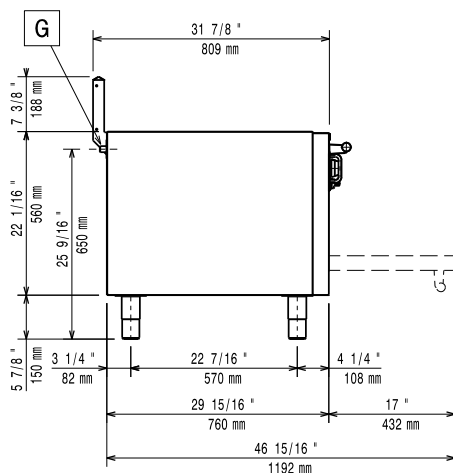

Gas

Gas Power:

169152 (AFG36)

34000 Btu/hr (10 kW)

Gas Type Option:

LPG

Gas Inlet:

1/2"

Key Information:

Oven working Temperature: 70 °C MIN; 310 °C MAX

Oven Cavity Dimensions

(width): 497 mm

Oven Cavity Dimensions

(height): 380 mm

Oven Cavity Dimensions

(depth): 680 mm

External dimensions, Height: 898 mm

External dimensions, Width: 915 mm

External dimensions, Depth: 807 mm

Net weight: 100 kg

Shipping height: 1144 mm

Shipping width: 975 mm

Shipping depth: 956 mm

Shipping volume: 1.07 m³

Shipping volume: 37.65 ft³ (1.07 m³)

EMPower
Static Gas Oven Base 36"

The company reserves the right to make modifications to the products without prior notice. All information correct at time of printing.

2016.12.01