



# Electrolux

## EMPower Two (2) Zone Electric Induction Top 16"

ITEM # \_\_\_\_\_  
MODEL # \_\_\_\_\_  
NAME # \_\_\_\_\_  
SIS # \_\_\_\_\_  
AIA # \_\_\_\_\_



EMPower

Two (2) Zone Electric Induction Top 16"

169107 (AIZ16)

EMPower Induction Top,  
Ele, 16"(2) 3.5kW

### Short Form Specification

#### Item No.

EMPower unit to be Electrolux Two (2) Zone Electric Induction Top. EMPower unit to have a 6 mm thick seamless Ceran® glass cooking surface with two (2) independently controlled 3,5 kW induction zones. Control knobs provide smooth, continuous rotation from min to max power level. Power ON lamp for each zone located on the glass surface. Induction plates with overheating safety device. Full length Stainless Steel air filter removable for easy cleaning. All major components can be accessed from the front of the appliance for ease of maintenance. Worktop in AISI 304 Stainless Steel. Front and side panels in Stainless Steel with Scotch Brite finish. Special heavy duty chrome plated knobs for durability and easy cleaning. The configuration of bezels and knobs provides high level of protection against water infiltrations. Right-angled side edges to allow flush fitting joints between EMPower units. Supplied with 4" (102 mm) height adjustable, removable legs. EMPower unit may be installed on refrigerated base or open cupboard.



APPROVAL: \_\_\_\_\_

### Main Features

- This unit can not be installed on oven base.
- 6 mm thick glass-ceramic cooking surface with two (2) independently controlled 3,5 kW induction zones.
- Control knobs provide smooth, continuous rotation from min to max power level.
- Power ON lamp for each zone located on the glass surface.
- Induction plates endowed with overheating safety device.
- Full length Stainless Steel air filter removable for easy cleaning.
- Low heat dissipation to the kitchen.
- The smooth, glass ceramic plate is not directly heated, so there is no burning on cooking surface.
- All major components can be accessed from the top and front of the appliance for ease of maintenance.
- Front and side panels in Stainless Steel with Scotch Brite finish.
- Special heavy duty chrome plated knobs for durability and easy cleaning.
- The configuration of bezels and knobs provides high level of protection against water infiltrations.
- Right-angled side edges to allow flush fitting joints between units, eliminating gaps and possible dirt traps.
- Provided with kit for side-by-side connection between units for minimizing gaps and possible dirt traps.
- Supplied with 4" (102mm) height adjustable, removable legs.
- Unit may be installed on refrigerated base by removing the legs and inserting the special pins (optional accessory).
- Unit may be installed on open cupboard by removing the legs and inserting the screws provided as standard with the open cupboards.
- In compliance with ETL Certification (UL & NSF).

### Construction

- Worktop in 304 AISI stainless steel.
- 4 screws to install on the cupboard base are supplied with the unit.

### Optional Accessories

- EMPower 4 pins kit for mounting unit PNC 169048 to refrigerated/freezer. 1 kit is supplied with each EMPower refrigerated base ☐
- EMPower back mounted rear shelf-spacer, 16" unit ☐ PNC 169097
- Portioning Shelf 12" ☐ PNC 169173
- Portioning Shelf 16" ☐ PNC 169174



Electrolux

Two (2) Zone Electric Induction Top 16" EMPower

Electrolux Professional, Inc.

[www.electroluxusa.com/professional](http://www.electroluxusa.com/professional)

10200 David Taylor Drive, Charlotte, NC 28262 • Telephone Number: 866-449-4200 • Fax Number: 704-547-7401



# Electrolux

## EMPower Two (2) Zone Electric Induction Top 16"

Front

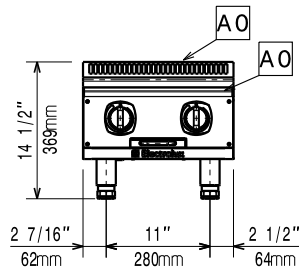

Top

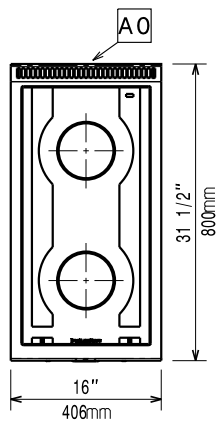

EI = Electrical connection  
EQ = Equipotential screw

Side

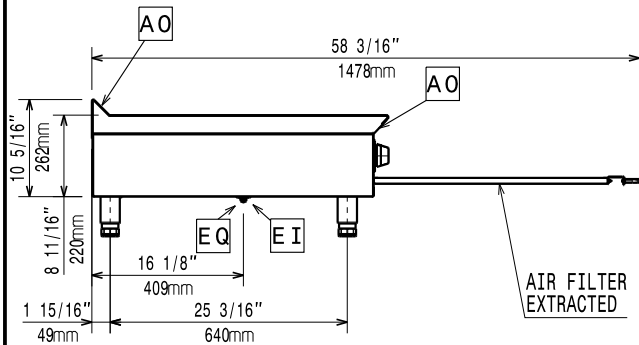

### Electric

Supply voltage:

169107 (AIZ16)

200-240 V/1 ph/60 Hz

Amps:

30 A

Total Watts:

7 kW

### Key Information:

Induction Top Dimensions  
(width):

16 " (406 mm)

Induction Top Dimensions  
(depth):

31 1/2" (800 mm)

External dimensions, Width:

16 " (406 mm)

External dimensions, Depth:

31 1/2" (800 mm)

External dimensions, Height:

14 5/8" (372 mm)

Net weight:

66 lbs (30 kg)

Shipping width:

17 15/16" (456 mm)

Shipping depth:

36 1/16" (916 mm)

Shipping height:

25 1/2" (648 mm)

Shipping weight:

77 lbs (35 kg)

Shipping volume:

9.56 ft<sup>3</sup> (0.27 m<sup>3</sup>)

EMPower  
Two (2) Zone Electric Induction Top 16"

The company reserves the right to make modifications to the products without prior notice. All information correct at time of printing.

2016.11.08