



Electrolux

Modular Cooking Range Line 900XP Gas Bain Marie Top Full module

ITEM # _____
MODEL # _____
NAME # _____
SIS # _____
AIA # _____



Electrolux

Modular Cooking Range Line
900XP Gas Bain Marie Top Full module



Modular Cooking Range Line

900XP Gas Bain Marie Top Full module

391110 (E9BMGHB000)

Full module gas bain-marie
top

Short Form Specification

Item No.

Suitable for natural or LPG gas. Used to keep cooked food at serving temperature using hot water inside the well. Water temperature to be controlled by thermostat with maximum temperature of 90 °C. Exterior panels of unit in stainless steel with Scotch Brite finish. Extra strength work top in heavy duty 2 mm stainless steel. Right-angled side edges to allow flush-fitting junction between units.

APPROVAL: _____

Main Features

- Bain Marie used for keeping cooked food at serving temperatures using hot water.
- Burners in stainless steel with flame failure device and protected pilot light.
- Piezo ignition.
- Water basin is seamlessly welded into the top of the appliance.
- Filling water level is plate-marked on the side of the well.
- Unit to feature manual refill of well.
- Water temperature controlled by thermostat with maximum temperature value of 90 °C.
- Basin drained by drain valve with overflow.
- Special insulation beneath cooking surface keeps heat on the plate without dispersion to the base.
- Unit to have perforated false bottom and runner support for GN containers.
- All major compartments located in front of unit for ease of maintenance.
- The special design of the control knob system guarantees against water infiltration.
- IPX5 water protection.

Construction

- Unit is 930 mm deep to give a larger working surface area.
- All exterior panels in Stainless Steel with Scotch Brite finishing.
- AISI 304 stainless steel worktop, 2mm thick.
- Model has right-angled side edges to allow flush fitting joints between units, eliminating gaps and possible dirt traps.

Optional Accessories

- | | |
|---|--|
| • Junction sealing kit | PNC
206086 <input type="checkbox"/> |
| • Draught diverter, 150 mm diameter | PNC
206132 <input type="checkbox"/> |
| • Matching ring for flue condenser, 150 mm diameter | PNC
206133 <input type="checkbox"/> |
| • Kit 4 wheels - 2 swivelling with brake - it is mandatory to install base support and wheels | PNC
206135 <input type="checkbox"/> |
| • Support for bridge type installation, 800mm | PNC
206137 <input type="checkbox"/> |
| • Support for bridge type installation, 1000mm | PNC
206138 <input type="checkbox"/> |
| • Support for bridge type installation, 1200mm | PNC
206139 <input type="checkbox"/> |
| • Support for bridge type installation, 1400mm | PNC
206140 <input type="checkbox"/> |

- Support for bridge type installation, 1600mm PNC 206141
☐
- Flue condenser for 1 module, 150 mm diameter PNC 206246
☐
- Water column with swivel arm (water column extension not included) PNC 206289
☐
- Water column extension for 900 line PNC 206290
☐
- Chimney upstand, 800mm PNC 206304
☐
- Base support for feet or wheels - 800mm (700/900) PNC 206367
☐
- Chimney grid net, 400mm (700XP/900) PNC 206400
☐
- Side handrail-right/left hand (900XP) PNC 216044
☐
- Frontal handrail, 800mm PNC 216047
☐
- Frontal handrail, 1200mm PNC 216049
☐
- Frontal handrail, 1600mm PNC 216050
☐
- Large handrail - portioning shelf, 400mm PNC 216185
☐
- Large handrail - portioning shelf, 800mm PNC 216186
☐
- 2 side covering panels for top appliances PNC 216278
☐
- Pressure regulator for gas units PNC 927225
☐

Front

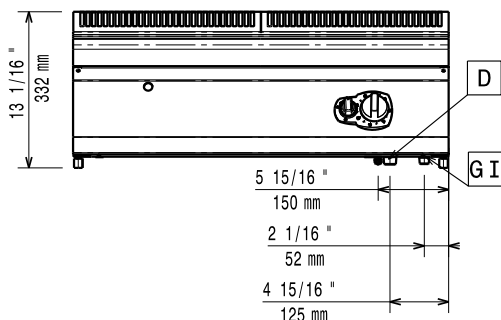

Top

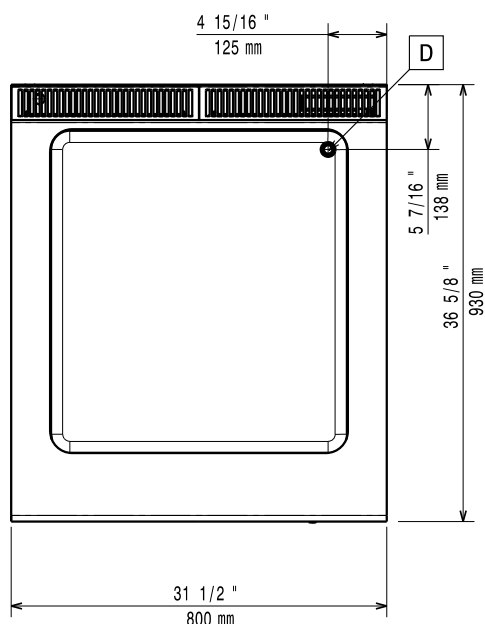

D = Drain
EQ = Equipotential screw
G = Gas connection

Side

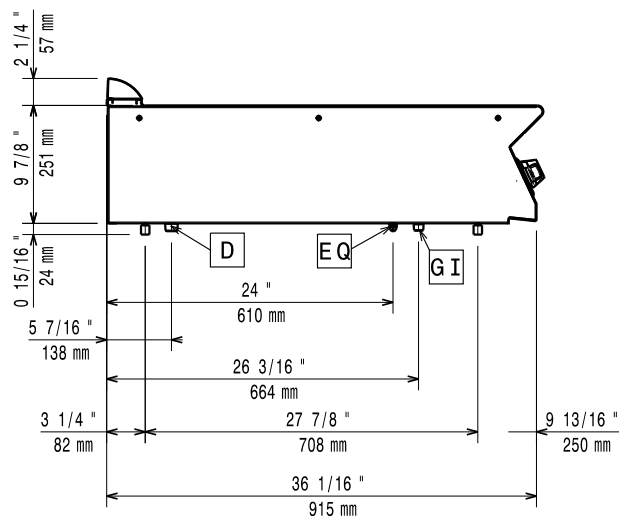

Gas

Gas Power:

391110 (E9BMGHB000)

21135.8 Btu/hr (6.2 kW)

Gas Type Option:

LPG; Natural Gas

Gas Inlet:

3/4"

Natural gas - Pressure:

7" w.c. (17.4 mbar)

LPG Gas Pressure:

11" w.c. (27.7 mbar)

Water:

Water Drain:

50 mm

Key Information:

Usable well dimensions (width):

630 mm

Usable well dimensions (height):

160 mm

Usable well dimensions (depth):

685 mm

Thermostat Range:

30 °C MIN; 90 °C MAX

Net weight:

45 kg

Shipping weight:

65 kg

Shipping height:

540 mm

Shipping width:

1020 mm

Shipping depth:

860 mm

Shipping volume:

0.47 m³

If appliance is set up or next to or against temperature sensitive furniture or similar, a safety gap of approximately 150 mm should be maintained or some form of heat insulation fitted.