



Electrolux

Modular Cooking Range Line 700XP Half Module Freestanding Gas Char-Grill

ITEM # _____

MODEL # _____

NAME # _____

SIS # _____

AIA # _____



Modular Cooking Range Line

700XP Half Module Freestanding Gas Char-Grill

371237 (E7GRGDGCFU)

Half module gas grill free standing

Short Form Specification

Item No. _____

To be installed on height adjustable feet in stainless steel. High efficiency 8 kW stainless steel gas burners with flame failure device, protected by deflection trays. Suitable for natural gas or LPG. Cooking surface grids in cast iron, easily removable for cleaning. Cast iron grids can be rotated for the grilling of fish or meats. Exterior panels in stainless steel with Scotch Brite finish. One piece pressed work top in 1.5 mm thick stainless steel. Right-angled side edges to allow flush-fitting junction between units.

Main Features

- Stainless steel burners with flame failure device.
- Burners are protected by deflection trays to prevent fat dripping on them.
- Cast iron grids can be rotated on the right ribbed profile, to grill fish or meats.
- Stainless steel high splash guard on the rear and sides can be easily removed for cleaning and is dishwasher-safe.
- IPX4 water resistance certification.
- Unit delivered with four 50 mm legs in stainless steel as standard (all round Stainless steel kick plates as option).
- The low temperature of the external panels allow to work in safety.

Construction

- All exterior panels in Stainless Steel with Scotch Brite finishing.
- One piece pressed 1.5 mm work top in Stainless steel.
- Model has right-angled side edges to allow flush fitting joints between units, eliminating gaps and possible dirt traps.

APPROVAL: _____



Electrolux

Modular Cooking Range Line
700XP Half Module Freestanding Gas Char-Grill

Optional Accessories

- | | | | |
|---|------------|--|------------|
| • Junction sealing kit | PNC 206086 | • Stainless steel grid for free standing grills (700XP) | PNC 206414 |
| • Draught diverter, 120 mm diameter | PNC 206126 | • Stainless steel grid for free standing V-shaped grills (700XP) | PNC 206415 |
| • Matching ring for flue condenser, 120 mm diameter | PNC 206127 | • Scraper for grids with drainage channels - top grills | PNC 206421 |
| • Kit 4 wheels - 2 swivelling with brake - it is mandatory to install base support and wheels | PNC 206135 | • Scraper for free standing grills | PNC 206422 |
| • Flanged feet kit | PNC 206136 | • Base support for feet/wheels (600mm) | PNC 206431 |
| • Frontal kicking strip for concrete installation, 400mm | PNC 206147 | • 2 side covering panels for free standing appliances | PNC 216000 |
| • Frontal kicking strip for concrete installation, 800mm | PNC 206148 | • Frontal handrail, 400mm | PNC 216046 |
| • Frontal kicking strip for concrete installation, 1000mm | PNC 206150 | • Frontal handrail, 800mm | PNC 216047 |
| • Frontal kicking strip for concrete installation, 1200mm | PNC 206151 | • Frontal handrail, 1200mm | PNC 216049 |
| • Frontal kicking strip for concrete installation, 1600mm | PNC 206152 | • Frontal handrail, 1600mm | PNC 216050 |
| • Frontal kicking strip, 400mm (not for refr-freezer base) | PNC 206175 | • Large handrail - portioning shelf, 400mm | PNC 216185 |
| • Frontal kicking strip, 800mm (not for refr-freezer base) | PNC 206176 | • Large handrail - portioning shelf, 800mm | PNC 216186 |
| • Frontal kicking strip, 1000mm (not for refr-freezer base) | PNC 206177 | • Pressure regulator for gas units | PNC 927225 |
| • Frontal kicking strip, 1200mm (not for refr-freezer base) | PNC 206178 | | |
| • Frontal kicking strip, 1600mm (not for refr-freezer base) | PNC 206179 | | |
| • Kit 4 feet for concrete installation (not for 900 line free standing grill) | PNC 206210 | | |
| • Pair of side kicking strips | PNC 206249 | | |
| • Pair of side kicking strips for concrete installation | PNC 206265 | | |
| • Chimney upstand, 400mm | PNC 206303 | | |
| • Right and left side handrails | PNC 206307 | | |
| • Back handrail 800mm, Marine | PNC 206308 | | |
| • Flue condenser for 1/2 module, 120 mm diameter | PNC 206310 | | |
| • Base support for feet or wheels - 400mm (700/900) | PNC 206366 | | |
| • Base support for feet or wheels - 800mm (700/900) | PNC 206367 | | |
| • Base support for feet or wheels - 1200mm (700/900) | PNC 206368 | | |
| • Base support for feet or wheels - 1600mm (700/900) | PNC 206369 | | |
| • Base support for feet or wheels - 2000mm (700/900) | PNC 206370 | | |
| • Rear paneling - 600mm (700/900XP) | PNC 206373 | | |
| • Rear paneling - 800mm (700/900) | PNC 206374 | | |
| • Rear paneling - 1000mm (700/900) | PNC 206375 | | |
| • Rear paneling - 1200mm (700/900) | PNC 206376 | | |
| • Kit town gas nozzles (G150) for 700 grill | PNC 206389 | | |



Electrolux

Modular Cooking Range Line 700XP Half Module Freestanding Gas Char-Grill

Front

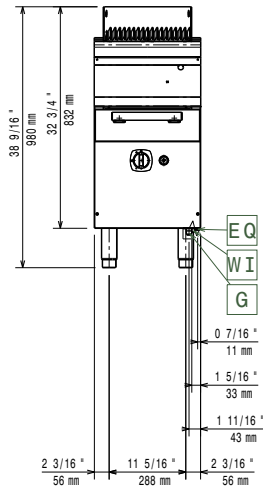

Top

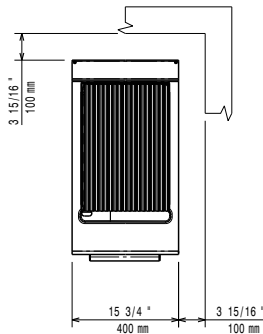

EQ = Equipotential screw
F = Fumes outlet
G = Gas connection

Side

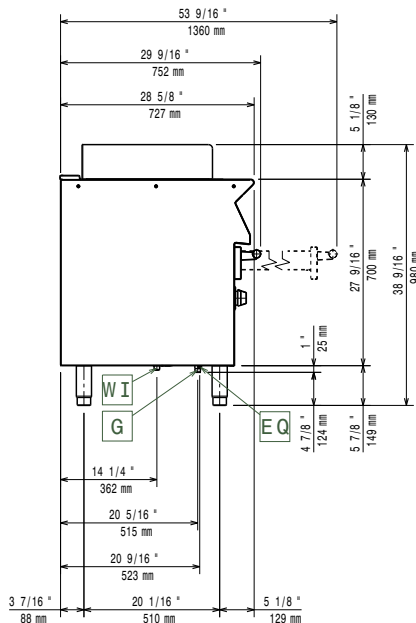

Gas

Gas Power:

371237 (E7GRGDGCFU) 27272 Btu/hr (8 kW)

Standard gas delivery:

Natural Gas G20 (20mbar)

Gas Type Option:

LPG;Town

Gas Inlet:

1/2"

Key Information:

Cooking surface width: 316 mm

Cooking surface depth: 478 mm

Net weight: 41 kg

Shipping weight: 55 kg

Shipping height: 1180 mm

Shipping width: 460 mm

Shipping depth: 810 mm

Shipping volume: 0.44 m³

If appliance is set up or next to or against temperature sensitive furniture or similar, a safety gap of approximately 150 mm should be maintained or some form of heat insulation fitted.



Modular Cooking Range Line
700XP Half Module Freestanding Gas Char-Grill

The company reserves the right to make modifications to the products without prior notice. All information correct at time of printing.

2017.06.23