



HEAVY DUTY ELECTRIC SEALED WELL TABLES WITH ENCLOSED BASE



Sealed Well with Drain

Enclosed Base
HDSW-3-240-BS Shown
with Optional TA-255P Casters

Item #: _____ Qty #: _____
Model #: _____
Project #: _____

FEATURES:

Heavy duty construction
All welded 300 series stainless steel
Sealed wells with manifold drains
Thermostatic controls
Removable front panel to access elements for ease of service
Supplied with dish shelf
Stainless steel shelf with removable 3/8" thick poly cutting board - Ships K.D.

MATERIAL:

TOP: 18 gauge #304 stainless steel with die stamped pan openings and self rimmed. (12" x 20" opening size)
BODY: 18 gauge #304 stainless steel
LEGS: 18 gauge stainless steel with fully adjustable stainless steel bullet foot
INSULATION: Fiberglass insulation between each compartment
DISH SHELF: 18 gauge #304 stainless steel
CUTTING BOARD: White Thermoplastic
HEAT COMPARTMENT: Sealed well pan with "M" shaped tubular element underneath
PLUMBING: Manifold drain assembly included

ELECTRICAL:

120V units yield 640 Watts
208V/240V dual voltage units yield 825 Watts at 208V and 1100 Watts at 240V
6' electrical cord with plug
Infinite control knobs
Indicator lights



Model #	Length	Width	# of Wells	Weight	Cubic Feet	Volts	NEMA Plug	Amps /Watts per Unit
HDSW-2-120-BS	31-13/16"	35-3/4"	2	225	31	120	5-20P	10.67/1280
HDSW-3-120-BS	47-1/8"	35-3/4"	3	340	45	120	5-20P	16/1920
HDSW-4-120-BS	62-7/16"	35-3/4"	4	430	60	120	L5-30P	21.33/2560
HDSW-2-240-BS	31-13/16"	35-3/4"	2	225	31	208/240	6-20P	10.67/2200
HDSW-3-240-BS	47-1/8"	35-3/4"	3	340	45	208/240	6-20P	13.75/3300
HDSW-4-240-BS	62-7/16"	35-3/4"	4	430	60	208/240	L6-30P	18.33/4400
HDSW-5-240-BS	77-3/4"	35-3/4"	5	520	74	208/240	L6-30P	22.91/5500
HDSW-6-240-BS	93-1/8"	35-3/4"	6	610	88	208/240	L6-30P	27.5/6600

NOTE: Units are not designed to cook or heat frozen or refrigerated foods. Food placed in tables should already be hot, and the table will maintain the proper temperatures

NEMA PLUGS: Your plug will look like this...

Includes:



Includes Manifold Drain



NEMA 5-20P



NEMA 6-20P



NEMA L5-30P



NEMA L6-30P



Customer Service Available To Assist You 1-800-645-3166 8:30 am - 8:00 pm E.S.T.

For Orders:

Email: customer@advancetabco.com or Fax To: 631-242-6900

For Smart Fabrication™ Quotes:

Email: smartfab@advancetabco.com or Fax To: 631-586-2933

DIMENSIONS and SPECIFICATIONS

TOL ± .125"

ALL DIMENSIONS ARE TYPICAL

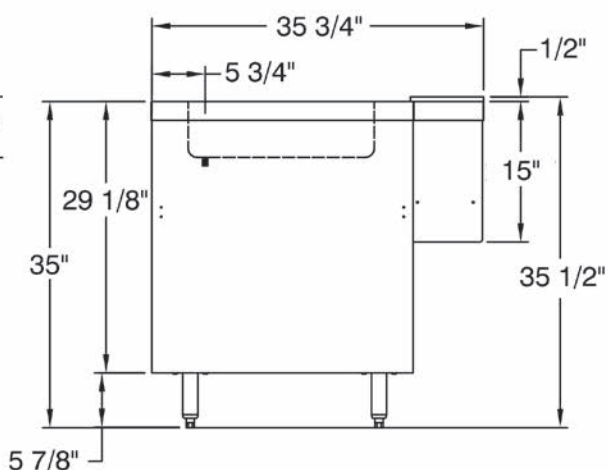
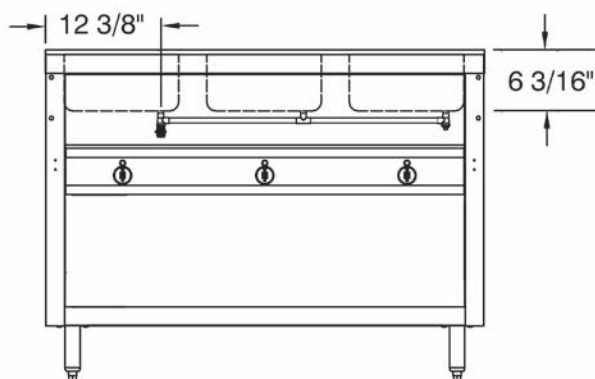
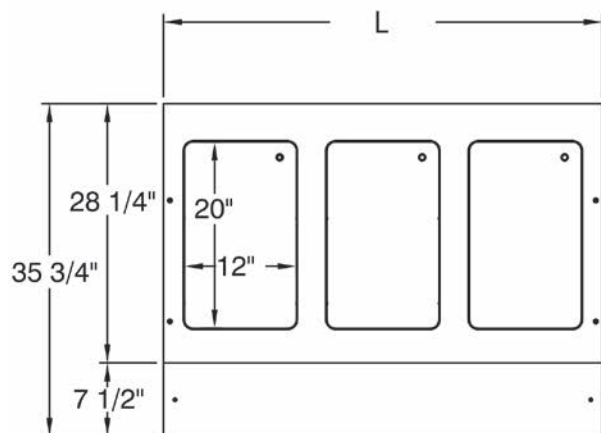

Food Table Shelving & Accessories

Visit our website for additional accessories



**Double Sided
Self-Serve Buffet Shelf
with Built-In Food Shield**

Model	Length	Approx Wt.	Cu. Ft.
TBS-2	31-13/16"	34 lbs.	2
TBS-3	47-1/8"	42 lbs.	3
TBS-4	62-7/16"	47 lbs.	4
TBS-5	77-3/4"	55 lbs.	4
TBS-6	93-1/8"	63 lbs.	4



**Acrylic Side Panels
for Buffet Shelf**

Add side panels to meet
additional NSF requirements
(2 panels per end)

**TBP-1 One End
TBP-2 Two Ends**

Field Installation Available



**Single Sided
Cafeteria Shelf
with Built-In Food Shield**

Model	Length	Approx Wt.	Cu. Ft.
TSS-2	31-13/16"	18 lbs.	2
TSS-3	47-1/8"	23 lbs.	3
TSS-4	62-7/16"	30 lbs.	4
TSS-5	77-3/4"	35 lbs.	4
TBS-6	93-1/8"	41 lbs.	4

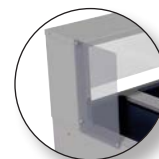

**Acrylic Side Panel
for Serving Shelf**

Add side panels to meet
additional NSF requirements.
(1 panel per end)

**TSP-1 One end
TSP-2 Two Ends**

Field Installation Available

