



Electrolux

Modular Cooking Range Line 700XP One Well Freestanding Gas Fryer 15 liter

ITEM # _____
MODEL # _____
NAME # _____
SIS # _____
AIA # _____



Electrolux



Modular Cooking Range Line
700XP One Well Freestanding Gas Fryer 15 liter

371070 (E7FRGD1GF0)

15-lt gas fryer free standing
with 1 "V" shape well
(external burners) and 1
basket

Short Form Specification

Item No.

To be installed on height adjustable feet in stainless steel. Two high efficiency 7 kW burners in stainless steel. Suitable for natural gas or LPG. Deep drawn V-shaped well. Oil drains through a tap into a container under the well. Exterior panels in stainless steel with Scotch Brite finish. One piece pressed work top in 1.5 mm thick stainless steel. Right-angled side edges to allow flush-fitting junction between units.

Main Features

- Unit to be mounted on 50mm height adjustable feet in stainless steel.
- Deep drawn V-Shaped well.
- Two high efficiency 7 kW burners in stainless steel with flame failure device attached to the outside of the well.
- Thermostatic regulation of oil temperature up to a maximum of 185 °C.
- Flame failure device on each burner.
- Overheat protection thermostat as standard on all units.
- Oil drains through a tap into a drainage container positioned under the well.
- All major compartments located in front of unit for ease of maintenance.
- Piezo spark ignition for added safety.
- Gas appliance supplied for use with natural or LPG gas, conversion jets supplied as standard.
- IPX 4 water protection.

Construction

- Interior of well with rounded corners for ease of cleaning.
- All exterior panels in Stainless Steel with Scotch Brite finishing.
- One piece pressed 1.5 mm work top in Stainless steel.
- Model has right-angled side edges to allow flush fitting joints between units, eliminating gaps and possible dirt traps.

Included Accessories

- 1 of Door for open base cupboard PNC 206350
- 1 of Full size basket for 14 and 15ltPNC 921691 free standing fryers

Optional Accessories

- Draught diverter, 120 mm diameter PNC 206126 ☐
- Matching ring for flue condenser, 120 mm diameter PNC 206127 ☐
- Kit 4 wheels - 2 swivelling with brake - it is mandatory to install base support and wheels PNC 206135 ☐
- Flanged feet kit PNC 206136 ☐
- Frontal kicking strip for concrete installation, 200mm PNC 206146 ☐
- Frontal kicking strip for concrete installation, 400mm PNC 206147 ☐
- Frontal kicking strip for concrete installation, 800mm PNC 206148 ☐

APPROVAL: _____

• Frontal kicking strip for concrete installation, 1000mm	PNC 206150	• Frontal handrail, 800mm	PNC 216047
• Frontal kicking strip for concrete installation, 1200mm	PNC 206151	• Frontal handrail, 1200mm	PNC 216049
• Frontal kicking strip for concrete installation, 1600mm	PNC 206152	• Frontal handrail, 1600mm	PNC 216050
• Frontal kicking strip, 200mm (not for refr-freezer base)	PNC 206174	• Large handrail - portioning shelf, 400mm	PNC 216185
• Frontal kicking strip, 400mm (not for refr-freezer base)	PNC 206175	• Large handrail - portioning shelf, 800mm	PNC 216186
• Frontal kicking strip, 800mm (not for refr-freezer base)	PNC 206176	• Full size basket for 14 and 15lt free standing fryers	PNC 921691
• Frontal kicking strip, 1000mm (not for refr-freezer base)	PNC 206177	• 2 half size baskets for 12, 14 and 15lt fryers	PNC 921692
• Frontal kicking strip, 1200mm (not for refr-freezer base)	PNC 206178	• Filter for fryer oil collection basin for 7lt, 14lt, 15lt free standing fryers	PNC 921693
• Frontal kicking strip, 1600mm (not for refr-freezer base)	PNC 206179	• Unclogging rod for 15lt fryers drainage pipe	PNC 921695
• Kit 4 feet for concrete installation (not for 900 line free standing grill)	PNC 206210	• Deflector for floured products for 15lt fryers	PNC 921696
• Sediment tray for 15lt fryers	PNC 206235	• Pressure regulator for gas units	PNC 927225
• Pair of side kicking strips	PNC 206249		
• Pair of side kicking strips for concrete installation	PNC 206265		
• Chimney upstand, 400mm	PNC 206303		
• Right and left side handrails	PNC 206307		
• Flue condenser for 1/2 module, 120 mm diameter	PNC 206310		
• Door for open base cupboard	PNC 206350		
• Base support for feet or wheels - 400mm (700/900)	PNC 206366		
• Base support for feet or wheels - 800mm (700/900)	PNC 206367		
• Base support for feet or wheels - 1200mm (700/900)	PNC 206368		
• Base support for feet or wheels - 1600mm (700/900)	PNC 206369		
• Base support for feet or wheels - 2000mm (700/900)	PNC 206370		
• Rear paneling - 600mm (700/900XP)	PNC 206373		
• Rear paneling - 800mm (700/900)	PNC 206374		
• Rear paneling - 1000mm (700/900)	PNC 206375		
• Rear paneling - 1200mm (700/900)	PNC 206376		
• Chimney grid net, 400mm (700XP/900)	PNC 206400		
• Base support for feet/wheels (600mm)	PNC 206431		
• 2 side covering panels for free standing appliances	PNC 216000		
• Frontal handrail, 400mm	PNC 216046		

Front

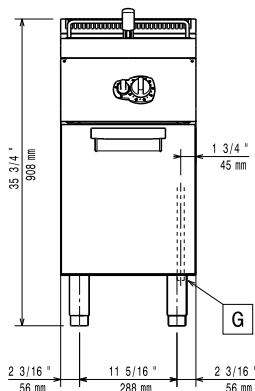

Top

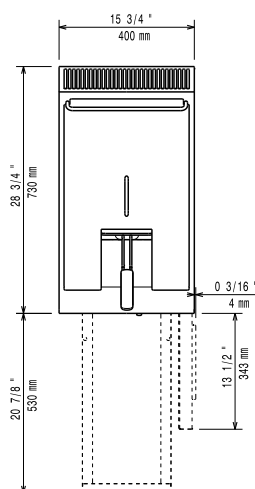

EQ = Equipotential screw
G = Gas connection

Side

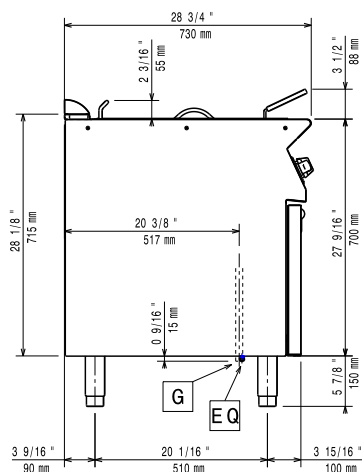

Gas

Gas Power:

371070 (E7FRGD1GF0)

47726 Btu/hr (14 kW)

Standard gas delivery:

Natural Gas

Gas Type Option:

LPG; Natural Gas

Gas Inlet:

1/2"

Key Information:

Usable well dimensions (width):

240 mm

Usable well dimensions (height):

505 mm

Usable well dimensions (depth):

380 mm

Well capacity:

13 lt MIN; 15 lt MAX

Thermostat Range:

105 °C MIN; 185 °C MAX

Net weight:

55 kg

Shipping weight:

55 kg

Shipping height:

1140 mm

Shipping width:

460 mm

Shipping depth:

820 mm

Shipping volume:

0.43 m³

If appliance is set up or next to or against temperature sensitive furniture or similar, a safety gap of approximately 150 mm should be maintained or some form of heat insulation fitted.