



Electrolux

Accessories Mixer tap with spout, foot pedal operated for sinks on legs

ITEM # _____
MODEL # _____
NAME # _____
SIS # _____
AIA # _____



Electrolux

Mixer tap with spout, foot pedal operated for sinks on legs

Accessories

Accessories

Mixer tap with spout, foot pedal operated for
sinks on legs

855317 (PAC49)

Mixer tap with spout, foot
pedal operated for sinks on
legs

Short Form Specification

Item No. _____

Includes water distribution valve, foot pedal, 1 meter flexible
tube and spout.

Main Features

- Heat-insulating and limescale-resistant thermoplastic components.
- Water flow: 16 l/min with 3 bar.
- All pre-rinse unit are equipped with check valves in compliance with EN 1717.
- Mounting hole: 29mm.
- Equipped with one foot pedal.

Construction

- Support spring in harmonic steel.
- Flexible hose in EPDM rubber, certified for portable water; reinforced with stainless steel double braid and transparent thermoplastic coating.
- The spray gun allows a progressive water flow with internal components in stainless steel and EPDM rubber certified for food.
- Faucet body made in hard chromium-plated brass, massive heavy-duty construction and it is resistant to temperature up to 90°C. Mounting shank: G3/4", 50mm long and ring nut for maximum stability and ease of installation.
- Hydraulic connection MG 1/2 male-threaded compression coupling.
- Stainless steel spray gun bracket with fiberglass body.
- 150mm long wall bracket in fiberglass.
- Riser pipe in AISI 316 stainless steel.

APPROVAL: _____

Front

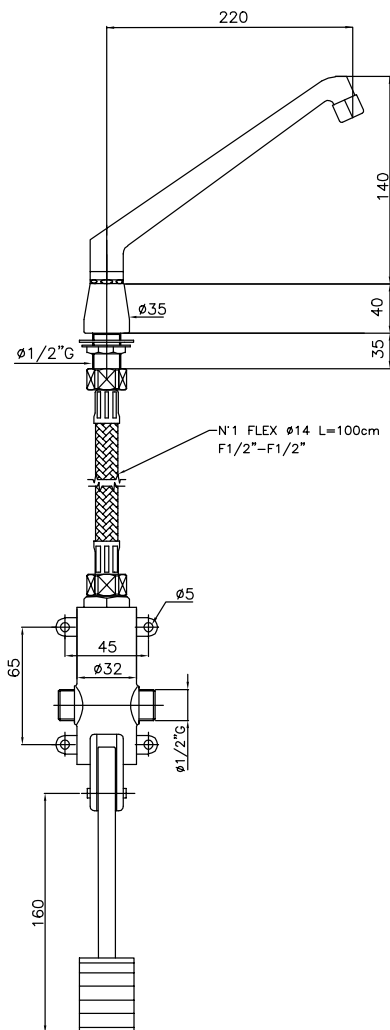

Side

