



Electrolux

Standard Preparation 1200 mm Vegetable Processing/ Washing Table

ITEM # _____
MODEL # _____
NAME # _____
SIS # _____
AIA # _____



Standard Preparation

1200 mm Vegetable Processing/Washing Table

132318 (TLV1210P)

Vegetable processing and washing table with polythene cutting board, 1070x320x180 mm bowl, scraping hole and upstand 1200mm

Short Form Specification

Item No.

50mm high worktop in 304 AISI stainless steel, 1mm in thickness. Integral radiused rear upstand, h=100mm. All-round apron. Square section legs 40x40mm on 1" height-adjustable feet in 304 AISI stainless steel. Bowl mm 1070x320x180h with overflow pipe and drain hole. Polythene cutting board on front mm 810x230x25h; waste scraping hole.

Main Features

- Model complies with international hygiene and cleanability standards.

Construction

- Table can be equipped with a mobile bin with lid for waste disposal (optional accessory).
- Unit features an all-round apron, a 1070 x 320 x 180 mm bowl, a scraping hole and a 810 x 230 x 25 mm polythene cutting board. The bowl is supplied with an overflow pipe and a drain hole.
- 100 mm upstand with 8 mm radiused corner and 13 mm deep, designed to be used against a wall.
- 50 mm worktop in 304 AISI stainless steel, 10/10 in thickness with upturned edges and reinforced waterproof underpanel, incorporates a layer of sound deadening materials.
- Square section legs and 40 mm height-adjustable feet in 304 AISI stainless steel.

Optional Accessories

- Stainless steel 60-lt mobile bin with lid ☐ PNC 120131
- Elbow operated tap with spray arm and spout ☐ PNC 855304
- Elbow operated mixer tap with short lever 3/4" ☐ PNC 855305
- Single plastic drain syphon 1,5" for work tables with bowl ☐ PNC 855306
- Mixer tap with spray, spout, short lever and thermostat, double hole ☐ PNC 855307
- Single brass drain syphon 1,5" for work tables with bowl ☐ PNC 855308
- Wall mixer tap with swivel spout 3/4" ☐ PNC 855310
- Mixer tap with spray arm 3/4" ☐ PNC 855311
- Prewash spray unit, single hole ☐ PNC 855315
- Mixer tap with spout, foot pedal operated for sinks on legs ☐ PNC 855317
- Mixer tap with swivel spout 3/4", single hole ☐ PNC 855319
- Elbow operated mixer tap with short spout 3/4", single hole ☐ PNC 855323
- Elbow operated tap with spray arm and spout, single hole ☐ PNC 855324
- Infrared mixer tap with spout 3/4", single hole ☐ PNC 855325
- HD mixer tap with spray arm 3/4", single hole ☐ PNC 855326
- Foot operated mixer tap (hot and cold) with spout 3/4" ☐ PNC 855328
- Mixer tap with spray and spout 3/4", single hole ☐ PNC 855329
- Lower shelf for 1200mm sink on legs ☐ PNC 855342

APPROVAL: _____



Electrolux

Standard Preparation
1200 mm Vegetable Processing/Washing Table

Front

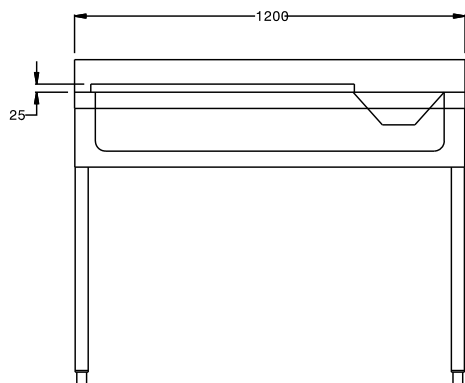

Top

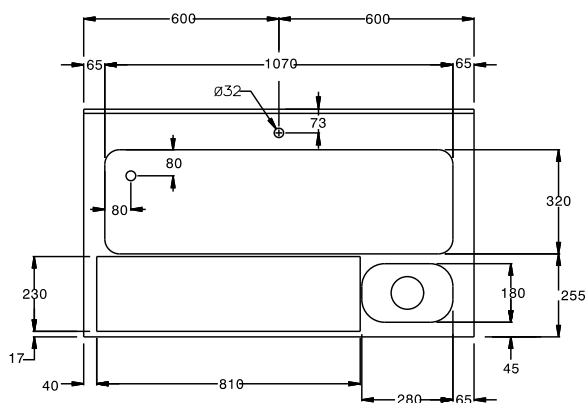

Side

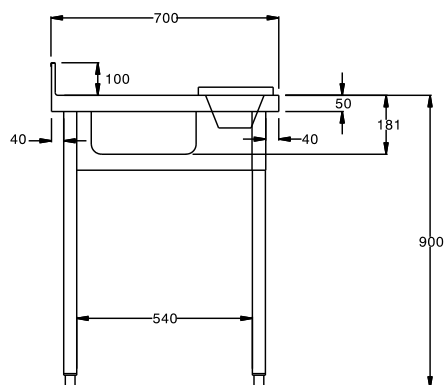

D = Drain
EQ = Equipotential screw

Key Information:

External dimensions, Height:	
132318 (TLV1210P)	1000 mm
External dimensions, Width:	1200 mm
External dimensions, Depth:	700 mm
Upstand Dimensions, Height:	100 mm
Upstand Dimensions, Depth:	13 mm
Upstand Dimensions, Radius:	R=8 mm
Bowls number	1
Bowl dimensions	1070x320xH180
Number of cutting boards	1
Cutting board dimensions - width	810 mm
Cutting board dimensions - depth	230 mm
Cutting board dimensions - height	25 mm
Worktop thickness:	50 mm
Net weight:	40 kg